

# WELCOME TO



*We invite you to share in our Pride ...*



**1 BEDROOM 1 BATH WALK THRU KITCHEN**  
723 SQ FT @ \_\_\_\_\_

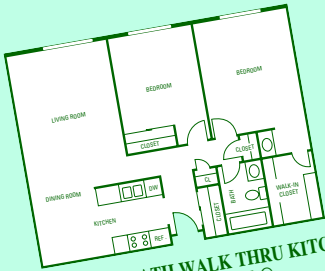

**2 BEDROOM 1-1/4 BATH WALK THRU KITCHEN**  
**WALKIN CLOSET** 957 SQ FT @ \_\_\_\_\_



**2 BEDROOM 2 BATH WITH LAUNDRY**  
**L KITCHEN** 1035 SQ FT @ \_\_\_\_\_



**2 BEDROOM 2 BATH WALKIN KITCHEN**  
**WITH LAUNDRY** 1045 SQ FT @ \_\_\_\_\_



**2 BEDROOM 2 BATH WITH LAUNDRY**  
**WALKIN KITCHEN** 1035 SQ FT @ \_\_\_\_\_



**3 BEDROOM 2 BATH WALK THRU KITCHEN,**  
**LAUNDRY & MASTER SUITE**  
1340 SQ FT @ \_\_\_\_\_

## FEATURES:

- Spacious 1-2-3 Bedroom Floor Plans
- 1 and 2 Baths
- Individual Central Heating and Air Conditioning
- Heat Paid
- Elevators
- Controlled Access Entry
- Many Walk-In Closets
- Vertical/Mini Blinds Furnished
- Ceiling Fans
- Mirrored Closet Doors
- Microwave
- Dishwasher & Disposal
- Electric Range
- Frost Free Refrigerator
- Plush Earth-Tone Carpet
- Balcony or Deck
- European Style Cabinets

## AMENITIES:

- Heated Indoor Pool
- Heated Outdoor Pool
- Sauna/Whirlpool
- Exercise Room
- Tanning Beds
- Community Room
- On-site Picnic and Playground Area

## FEATURES:

- Full Size Washer & Dryer in Many Apartments
- Vaulted Ceilings in Some Units
- Garages with Automatic Door Openers Available
- Cable TV Available

605-334-6900